

General Product Information:

ROXUL® products are mineral wool fibre insulations made from basalt rock and slag. This combination results in a non-combustible product with a melting point of approximately 2150°F (1177°C), which gives it excellent fire resistance properties. ROXUL mineral wool is a water repellent yet vapour permeable material.

Description & Common Applications:

The ComfortBoard™ FS product is a semi-rigid fibre insulation board produced of rock and is ideal for firestopping in concealed spaces of residential units. This product complies with the 2006 Building Code 9.10.16.3(2).

Compliance and Performance:

CAN/ULC-S702	Mineral Fibre Thermal Insulation for Buildings	Type 1, Complies
ASTM C 612	Mineral Fiber Block and Board Thermal Insulation	Type IVA, Complies

Fire Performance:

ASTM E 136	Behaviour of Materials at 750°C (1382°F)	Non-Combustible
CAN4 S114	Test for Non-Combustibility	Non-Combustible
ASTM E 84(UL 723)	Surface Burning Characteristics	Flame Spread = 5
		Smoke Developed = 5
CAN/ULC S102	Surface Burning Characteristics	Flame Spread = 5
		Smoke Developed = 10

Dimensional Stability:

ASTM C 356	Linear Shrinkage	0.35% @ 1200°F (650°C)
------------	------------------	------------------------

Moisture Resistance:

ASTM C 1104	Moisture Sorption	0.03%
-------------	-------------------	-------

Thermal Resistance:

ASTM C 518 (C 177)	R-value/inch @ 75°F	4.2 hr.ft².F/Btu
	RSI value/25.4 mm @ 24°C	0.74 m²K/W

Corrosive Resistance:

ASTM C 665	Corrosiveness to Steel	Pass
ASTM C 795 ****	Stainless Steel Stress Corrosion Specification as per Test Methods C871 and C692: U.S. Nuclear Regulatory Commission, Reg. Guide #1.36: U.S. Military Specifications MIL-I-24244 (all versions including B and C)	Conforms

Density:

ASTM C 612-00 – Actual	4.4 lbs/ft³	70kg/m³
------------------------	-------------	---------

Compressive Strength:

ASTM C 165	at 10%	114 psf (5.5 kPa)
	at 25%	250 psf (12 kPa)

Dimensions:

16" (width) x 48" (length)
406 mm (width) x 1219 mm (length)

Thickness:

Product thickness is available in 1".

*MASTER FORMAT 1995 EDITION **MASTER FORMAT 2004 EDITION
*** at the time of manufacturing

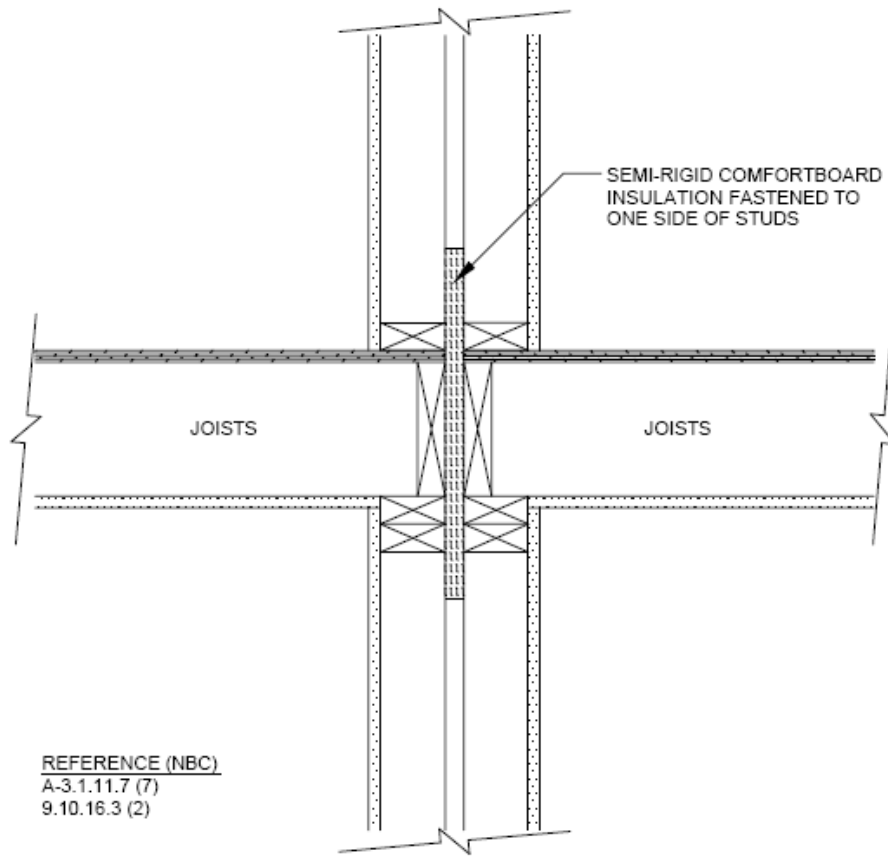

REFERENCE (NBC)
A-3.1.11.7 (7)
9.10.16.3 (2)

FIRE STOPPING DETAIL (CONCEALED SPACES)

Other ROXUL Products:

Please consult ROXUL for all your insulation needs. We have an extensive range of products for all applications from pipe insulation to commercial products to residential batts. ROXUL invites all inquiries and will act promptly to service all of your requirements.

Key Application Qualifiers:

- Easily cut
- Non-combustible
- Excellent sound absorbency
- Chemically inert
- Does not rot or sustain vermin
- Does not promote growth of fungi or mildew
- Low moisture sorption
- Water resistant
- CFC and HCFC free product and process
- Made from natural & recycled materials

*** "Provisions for lot testing may be required, consult manufacturer."

Note:

As ROXUL Inc. has no control over installation design and workmanship, accessory materials or application conditions, ROXUL Inc. does not warranty the performance or results of any installation containing ROXUL Inc's. products. ROXUL Inc's. overall liability and the remedies available are limited by the general terms and conditions of sale. This warranty is in lieu of all other warranties and conditions expressed or implied, including the warranties of merchantability and fitness for a particular purpose.

ROXUL INC.
www.roxul.com

Milton, Ontario Tel: 905-878-8474
Tel: 1-800-265-6878

Fax: 905-878-8077
Fax: 1-800-991-0110
Issued: February 1, 2010