

**General Product Information:**

ROXUL® products are mineral wool fibre insulations made from basalt rock and slag. This combination results in a non-combustible product with a melting point of approximately 2150°F (1177°C), which gives it excellent fire resistance properties. ROXUL mineral wool is a water repellent yet vapour permeable material.

**Description & Common Applications:**

The ComfortBoard™ FS product is a semi-rigid fibre insulation board produced of rock and is ideal for firestopping in concealed spaces of residential units. This product complies with the 2006 Building Code 9.10.16.3(2).

**Compliance and Performance:**

|            |  |                    |
|------------|--|--------------------|
| ASTM C 612 | Mineral Fiber Block and Board Thermal Insulation | Type IVA, Complies |
|------------|--|--------------------|

**Fire Performance:**

|                   |  |                      |
|-------------------|--|----------------------|
| ASTM E 136        | Behaviour of Materials at 750°C (1382°F) | Non-Combustible      |
| CAN4 S114         | Test for Non-Combustibility              | Non-Combustible      |
| ASTM E 84(UL 723) | Surface Burning Characteristics          | Flame Spread = 5     |
|                   |  | Smoke Developed = 5  |
| CAN/ULC S102      | Surface Burning Characteristics          | Flame Spread = 5     |
|                   |  | Smoke Developed = 10 |

**Dimensional Stability:**

|            |                  |                        |
|------------|------------------|------------------------|
| ASTM C 356 | Linear Shrinkage | 0.35% @ 1200°F (650°C) |
|------------|------------------|------------------------|

**Moisture Resistance:**

|             |                   |       |
|-------------|-------------------|-------|
| ASTM C 1104 | Moisture Sorption | 0.03% |
|-------------|-------------------|-------|

**Thermal Resistance:**

|                    |                          |                  |
|--------------------|--------------------------|------------------|
| ASTM C 518 (C 177) | R-value/inch @ 75°F      | 4.1 hr.ft².F/Btu |
|                    | RSI value/25.4 mm @ 24°C | 0.72 m²K/W       |

**Corrosive Resistance:**

|                 |   |          |
|-----------------|---|----------|
| ASTM C 665      | Corrosiveness to Steel  | Pass     |
| ASTM C 795 **** | Stainless Steel Stress Corrosion Specification as per Test Methods C871 and C692: U.S. Nuclear Regulatory Commission, Reg. Guide #1.36: U.S. Military Specifications MIL-I-24244 (all versions including B and C) | Conforms |

**Density:**

|                        |             |         |
|------------------------|-------------|---------|
| ASTM C 612-00 – Actual | 3.5 lbs/ft³ | 56kg/m³ |
|------------------------|-------------|---------|

**Compressive Strength:**

|            |        |                  |
|------------|--------|------------------|
| ASTM C 165 | at 10% | 71 psf (3.4 kPa) |
|            | at 25% | 209 psf (10 kPa) |

**Dimensions:**

24" (width) x 48" (length)  
610 mm (width) x 1219 mm (length)

**Thickness:**

Product thickness is available in 1".

\*MASTER FORMAT 1995 EDITION \*\*MASTER FORMAT 2004 EDITION  
\*\*\* at the time of manufacturing

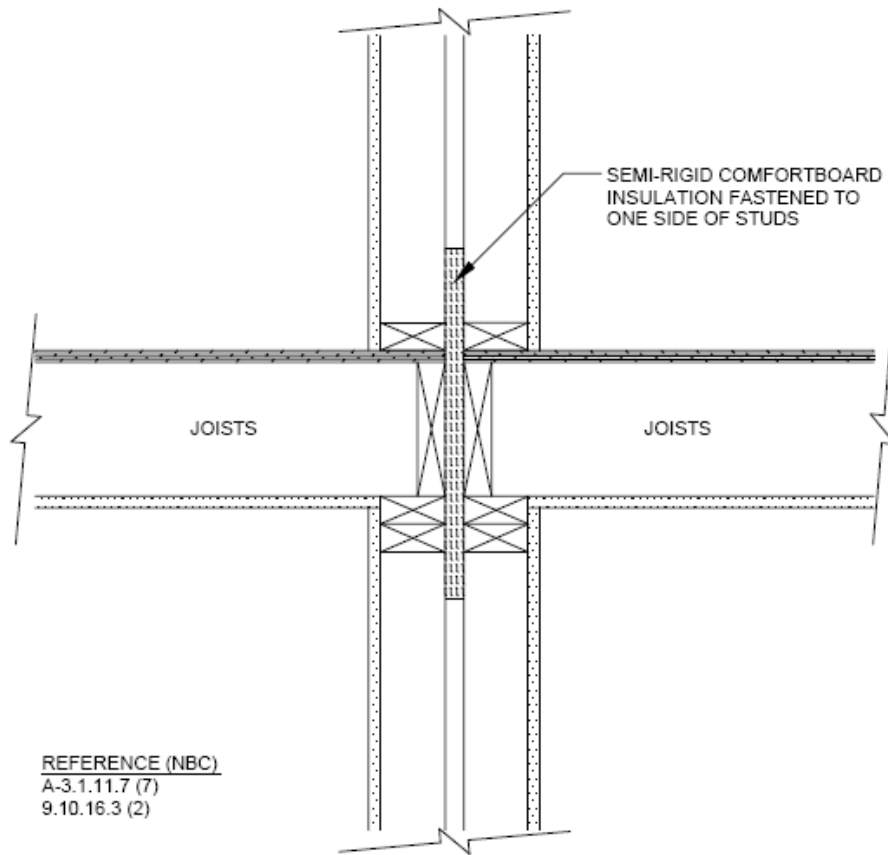

REFERENCE (NBC)  
A-3.1.11.7 (7)  
9.10.16.3 (2)

FIRE STOPPING DETAIL (CONCEALED SPACES)

### Other ROXUL Products:

Please consult ROXUL for all your insulation needs. We have an extensive range of products for all applications from pipe insulation to commercial products to residential batts. ROXUL invites all inquiries and will act promptly to service all of your requirements.

### Key Application Qualifiers:

- Easily cut
- Non-combustible
- Excellent sound absorbency
- Chemically inert
- Does not rot or sustain vermin
- Does not promote growth of fungi or mildew
- Low moisture sorption
- Water resistant
- CFC and HCFC free product and process
- Made from natural & recycled materials

\*\*\* "Provisions for lot testing may be required, consult manufacturer."

### Note:

As ROXUL Inc. has no control over installation design and workmanship, accessory materials or application conditions, ROXUL Inc. does not warranty the performance or results of any installation containing ROXUL Inc's. products. ROXUL Inc's. overall liability and the remedies available are limited by the general terms and conditions of sale. This warranty is in lieu of all other warranties and conditions expressed or implied, including the warranties of merchantability and fitness for a particular purpose.

**ROXUL INC.**  
[www.roxul.com](http://www.roxul.com)

**Milton, Ontario Tel: 905-878-8474**  
**Tel: 1-800-265-6878**

**Fax: 905-878-8077**  
**Fax: 1-800-991-0110**

Issued: February 1, 2010